

6 | 5 | 4 | 3 | 2 | 1

D
C
B
A

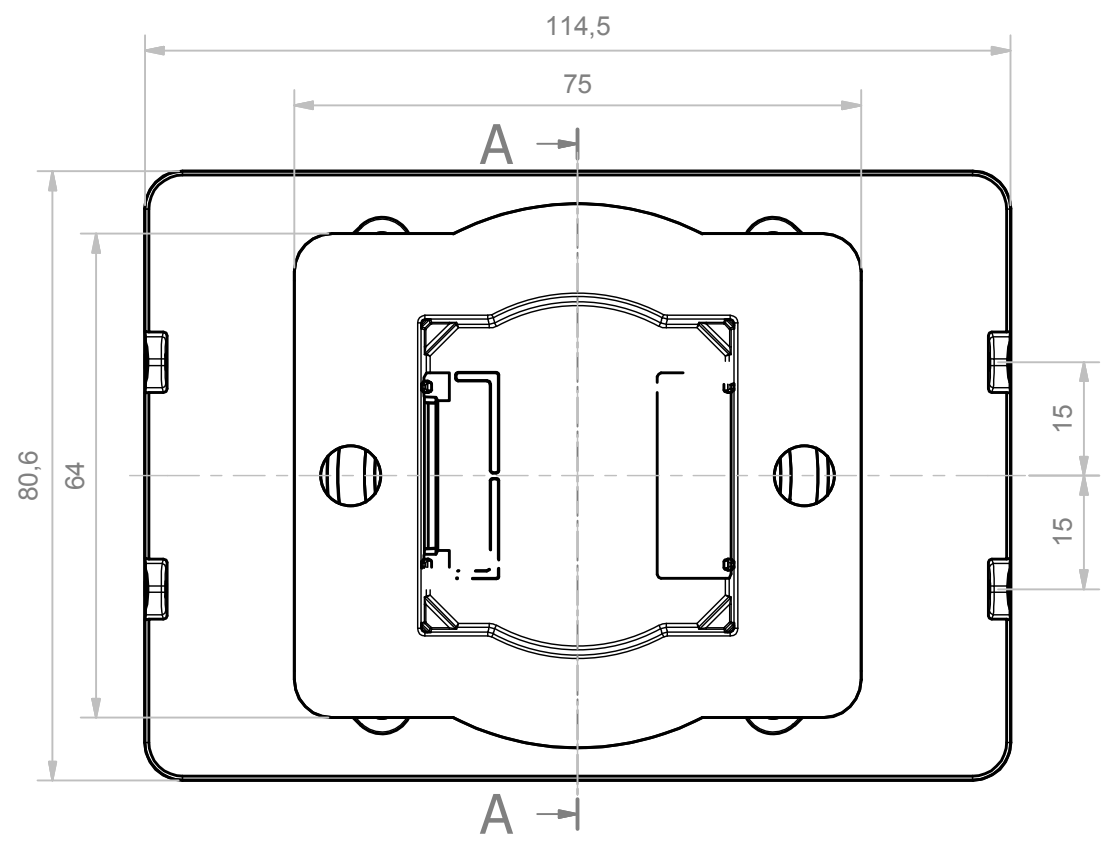

A-A (1 : 1)

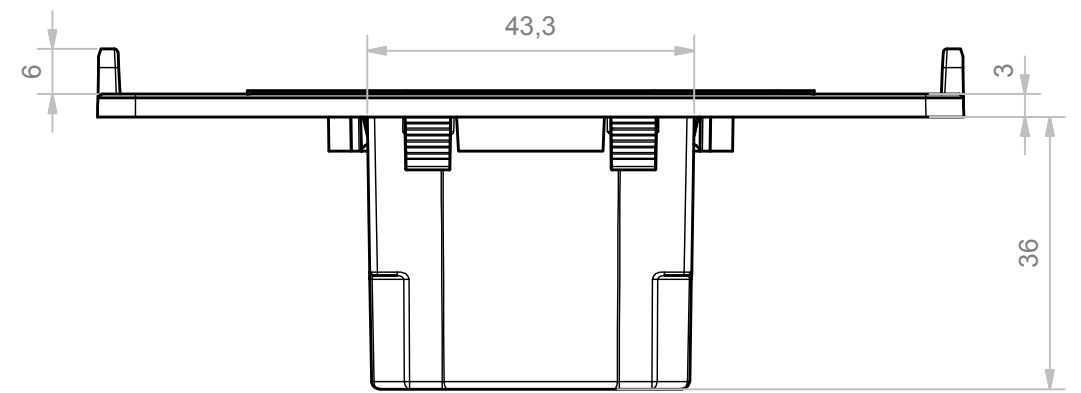
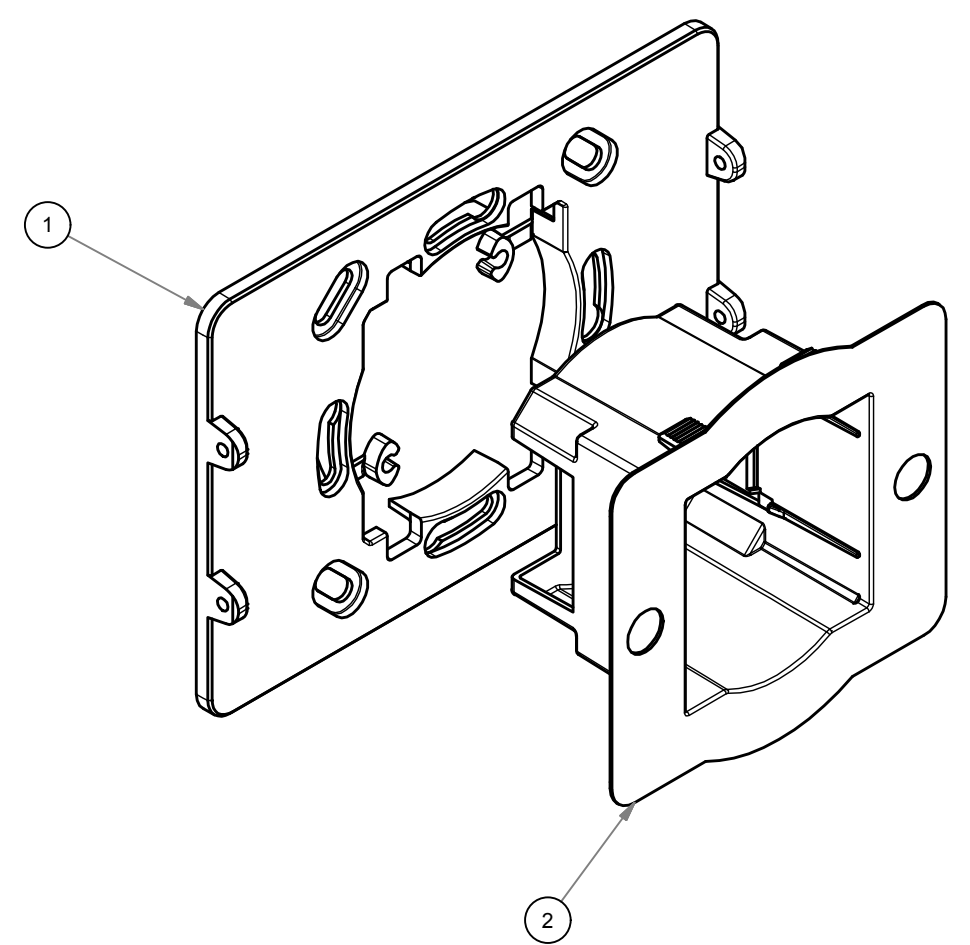
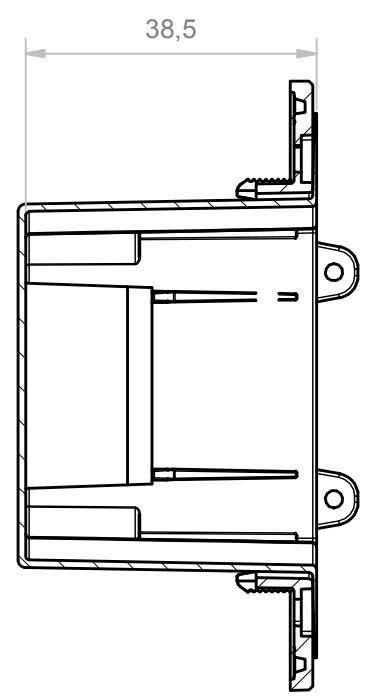

RIF.	Q.TY	DESCRIPTION	DRAWING
1	1	BACK FRAME ITOUCH 80X120 FOR ENCLOSURE D60	2.010.00003
2	1	BODY ENCLOSURE D60 H30	2.020.00011

General Tolerance UNI EN 22768/1 Media (m)				
from 0.5 to 3	from 3 to 6	from 6 to 30	from 30 to 120	from 120 to 400
± 0.1	± 0.1	± 0.2	± 0.3	± 0.5
Scale: 1 : 1	Sheet nr.: 1 / 1	Drawn: N.R.	Checked: F.F.	Date: 23/08/2018
Dimension in mm		Material:	Weight:	Cod. Mold:
 www.italtronic.com techcare@italtronic.com		Description: KIT PLACCA POSTERIORE PER SCATOLA D60 H30 MOUNTING FRAME KIT FOR ENCLOSURE D60 H30		Rev. 01
				Drawing nr. 3.010.00002

29/08/2018 N.R. Updated cartouche with new code (code passed C-06658-00)

RESERVED PROPERTY: The present drawing cannot be reproduced or communicated to 3rd parties, even partially, without the authorization of ITALTRONIC Srl. Italtronic reserves to protect its own rights according to the law.

6 | 5 | 4 | 3 | 2 | 1